

# SurePath™ technology is changing cervical cancer screening for the better.

SurePath™ unique collection device(s) all have detachable heads so you get more of the sample everytime<sup>1</sup>.

- ▶ Since the heads of these devices are detached and deposited into the vial, 100% of the collected sample can be sent to the lab for processing.
- ▶ Alternately a rinse and swirl technique can result in discarding up to 37% of the sample collected during cell transfer<sup>1</sup>, which could mean the difference between finding an abnormality and missing it.
- ▶ Today, with ACOG<sup>2</sup> and ACS<sup>3</sup> recommendations for longer cervical cancer screening intervals, you can't afford to put your patients or your practice at risk by discarding any of the sample using a rinse and swirl technique.

Think about what SurePath™ unique sample collection could mean to her. Protect her and your practice. Choose SurePath™.



SurePath™ is the only Pap test available today with a **64.4% increase in HSIL+ detection<sup>4</sup>**.

## SurePath™ is easy to use:

step

### 1. Collect

Collect the cytology sample using either a broom-like device or combination brush/plastic spatula with detachable heads. Follow manufacturer's collection instructions for detachable head device(s).



step

### 2. Drop

Drop the detachable head device(s) into the SurePath™ vial.



step

### 3. Send

Place the cap on the vial and tighten. Send the SurePath™ vial to the lab for processing.



<sup>1</sup> Bigras G et al. Keeping collecting device in liquid medium is mandatory to ensure optimized liquid-based cervical cytology sampling. *Journal of Lower Genital Tract Disease*, Vol. 7(3), 2003; 168-174. <sup>2</sup> ACOG Practice Bulletin, No. 45, August 2003. Clinical Management Guidelines for Cervical Cytology Screening. American Cancer Society. Early Detection of Cervical Cancer. Nov/Dec 2002, Vol. 52(6). <sup>3</sup> American Cancer Society. Early Detection of Cervical Cancer. Nov/Dec 2002, Vol. 52(6). <sup>4</sup> Compared to conventional Pap smear. See PrepStain™ package insert, Table 26 for these clinical sites and these study populations. *Note: Site to site variations in performance are expected. Each laboratory must carefully monitor the quality of its work.*  
The PrepStain™ System produces SurePath™ slides that are intended as replacements for conventional gynecological Pap smears. SurePath™ slides are intended for use in the screening and detection of cervical cancer, pre-cancerous lesions, atypical cells and all other cytologic categories as defined by The Bethesda System for Reporting Cervical/Vaginal Cytologic Diagnoses. Specimens should be collected using a broom-type or combination brush/plastic spatula sampling device(s). Please refer to applicable package insert for a complete list of indications for use, training requirements, limitations, warnings, and precautions.

**SUREPATH™**

liquid-based Pap test

Now You're Sure.™

# SurePath™ is Easy to Use.

SurePath™ offers several collection device choices.

## Option 1

SurePath™ Sample Collection with Broom-Type Device with Detachable Head<sup>5</sup>

### 1. Collect

Insert the Rovers Cervix-Brush® into the endocervical canal. Rotate brush five times in a clockwise direction.

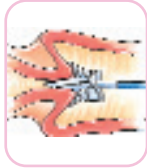

### 2. Drop

Drop the detachable head of the device into the SurePath™ vial.



### 3. Send

Place the cap on the vial and tighten. Send the SurePath™ vial to the lab for processing.



Contraindication: The Cervex-Brush® should not be used on patients after the first 10 weeks of pregnancy.

## Option 2

SurePath™ Sample Collection with Combination Brush/plastic Spatula Device with Detachable Heads<sup>6</sup>

### 1A. Collect

Insert the contoured end of the Pap Perfect® plastic spatula and rotate 360° around the entire exocervix.



### 1B. Collect

Insert Cytobrush® Plus GT into the endocervix until only the bottom-most bristles are exposed at the os. Slowly rotate 1/4 to 1/2 turn in one direction. To reduce unnecessary bleeding, do not over-rotate brush.

### 2A. Drop

Snap the device handle and drop the detachable head of the device into the SurePath™ vial.



### 2B. Drop

Snap the device handle and drop the detachable head of the device into the SurePath™ vial.

### 3A. Next

Place cap on vial; do not tighten cap until 'Step #3B Send.' Go to Cytobrush® Plus GT 'Step #1B. Collect.'



### 3B. Send

Place the cap on the vial and tighten. Send the SurePath™ vial to the lab for processing.

Warning: Do Not Use Cytobrush® Plus GT on pregnant patients or for endometrial sampling. See SurePath™ Sample Collection Kit product insert for complete Directions for Use.

## Alternative Methods to Detach Heads of Collection Devices: Two-Hand 'SNAP'<sup>6</sup>

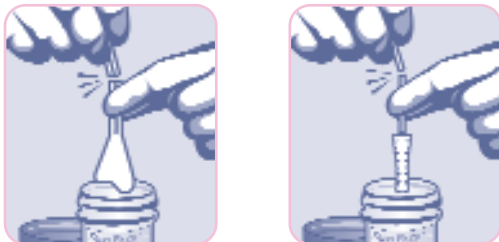

Do not touch the head of the device while detaching.

## Alternative Methods to Detach Heads of Collection Devices: Cap-assisted 'SNAP'<sup>6</sup>

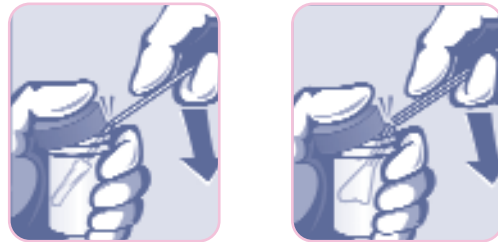

Care must be taken to avoid splashing and/or contamination of the head(s) of the device(s).

# SUREPATH™

from **TRIPATH IMAGING**

Now You're Sure.™

liquid-based Pap test